



Otak Inc.
17355 SW Boones Ferry Rd.
Lake Oswego, OR 97035
Phone 503.635.3618
Fax 503.635.5395

St. Helens Transit Center

SE corner of Deer Island Rd and Oregon Street
St. Helens, OR

Columbia County Rider

230 Strand Street
St. Helens, OR 97051

Phone: 503-397-1035

Site Layout Plan

100% Site Review Package Submittal - October 15, 2010

#	Date	Description
Revisions	10/15/10	
Date		
AMO		
Designed By		
MRK		
Drawn By		
KJB		
Checked By		
15659		
Project Number		

C1.0

Sheet Number 1 of
Copyright 2010 ©
If this drawing is less than 24" x 36",
it has been reduced. Scale accordingly.

General Notes

1. ALL DIMENSIONS ARE MEASURED TO FACE OF CURB OR CENTER OF STRIPE UNLESS NOTED OTHERWISE.
2. ALL CURB RETURN RADIUS ARE 3' UNLESS NOTED OTHERWISE.
3. SEE SHEET C2.1 FOR IMPROVEMENTS TO DEER ISLAND ROAD AND OREGON STREET.
4. SIDEWALKS ARE 6' MINIMUM FROM BACK OF CURB TO BACK OF WALK UNLESS NOTED OTHERWISE.
5. SEE ARCHITECTURAL PLANS FOR TRANSIT CENTER BUILDING DETAILS.
6. ALL PARKING STALLS TO BE 9' WIDE X 18' DEEP UNLESS OTHERWISE SPECIFIED.

Key Notes

- 1 CONSTRUCT CURB END TRANSITION PER DETAIL, SHEET C2.5
- 2 CONSTRUCT STD MONOLITHIC CURB & GUTTER PER CITY OF ST. HELENS DETAIL 200
- 3 CONSTRUCT TYPE 'A' STANDARD CURB, PER CITY OF ST. HELENS DETAIL 210
- 4 CONSTRUCT SIDEWALK PER CITY OF ST. HELENS DETAIL 220 (WIDTH AS SPECIFIED ON PLANS)
- 5 CONSTRUCT WHEELCHAIR ACCESS RAMP PER CITY OF ST. HELENS DETAIL 230
- 6 CONSTRUCT MODIFIED WHEELCHAIR ACCESS RAMP PER DETAIL, SHEET C2.5
- 7 SEE SHEET L3.2 FOR SIDEWALK SCORING DETAILS
- 8 INSTALL BIKE RACKS PER DETAIL, SHEET L3.2
- 9 SEE SHEET C4.0 FOR SIGNING AND STRIPING
- 10 INSTALL RECYCLED PLASTIC WHEELSTOP PER DETAIL, SHEET C2.5
- 11 CONSTRUCT 6' CHAIN LINK FENCE, W/ 3 STRANDS BARBED WIRE, PER ODOT STD. DWG. RDB15, MODIFIED.
- 12 CONSTRUCT 6' WOOD FENCE. CONNECT TO EXISTING FENCE AND BUILDING. REPAIR EXISTING FENCE AT CONNECTION POINT WHERE NECESSARY.
- 13 INSTALL BUS SHELTER PER MANUFACTURER.
- 14 FUTURE BUS SHELTER LOCATION.
- 15 INSTALL SITE LIGHTING. DRAWING BY OTHERS.
- 16 EXISTING CONTROL POINT
PK NAIL AND WASHER LABELED 'OTAK CONTROL'
N=811856.21 E=7613065.65
ELEV.=115.67 (DATUM: NAVD88)
- 17 EXISTING CONTROL POINT
IRON ROD ON PROPERTY CORNER
N=811350.72 E=7613104.08
ELEV.=104.87 (DATUM: NAVD88)
- 18 CC RIDER MONUMENT SIGN. CONTRACTOR TO FABRICATE AND INSTALL AS DIRECTED. COORDINATE EXACT SIGN LOCATION WITH PROJECT MANAGER.

Layout Point Coordinates

POINT	NORTHING	EASTING
1	N 811862.8470	E 7612879.9743
2	N 811846.1220	E 7612931.3189
3	N 811831.3524	E 7612985.1397
4	N 811852.2363	E 7612854.4319
5	N 811862.8470	E 7612943.4660
6	N 811799.8819	E 7612884.5490
7	N 811773.5708	E 7612971.7476
8	N 811768.0626	E 7612893.2975
9	N 811762.1445	E 7612981.1118
10	N 811741.0559	E 7613100.4734
11	N 811756.9623	E 7613158.3266
12	N 811740.9895	E 7612818.1944
13	N 811724.3147	E 7612875.8657
14	N 811715.9948	E 7612907.6132
15	N 811862.8470	E 7612987.6540
16	N 811719.3624	E 7612868.4681
17	N 811702.6374	E 7612919.8128
18	N 811664.2293	E 7612985.2167
19	N 811704.2914	E 7612997.0182
20	N 811654.2761	E 7613124.3330
21	N 811644.1486	E 7613189.3440
22	N 811673.6107	E 7612815.1774
23	N 811631.7983	E 7612943.5390
24	N 811620.0923	E 7613177.2902
25	N 811610.5485	E 7613142.5783
26	N 811615.2220	E 7613197.2972
27	N 811389.9681	E 7612880.3277
28	N 811508.5865	E 7612963.2561
29	N 811501.9854	E 7613007.7693
30	N 811355.8954	E 7613110.0916
31	N 811410.1053	E 7613253.6928

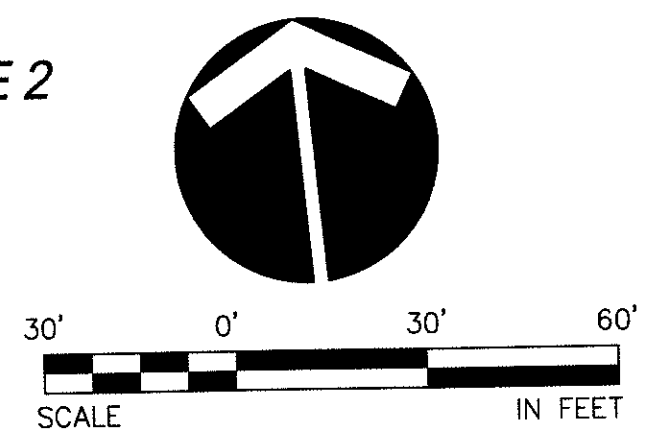
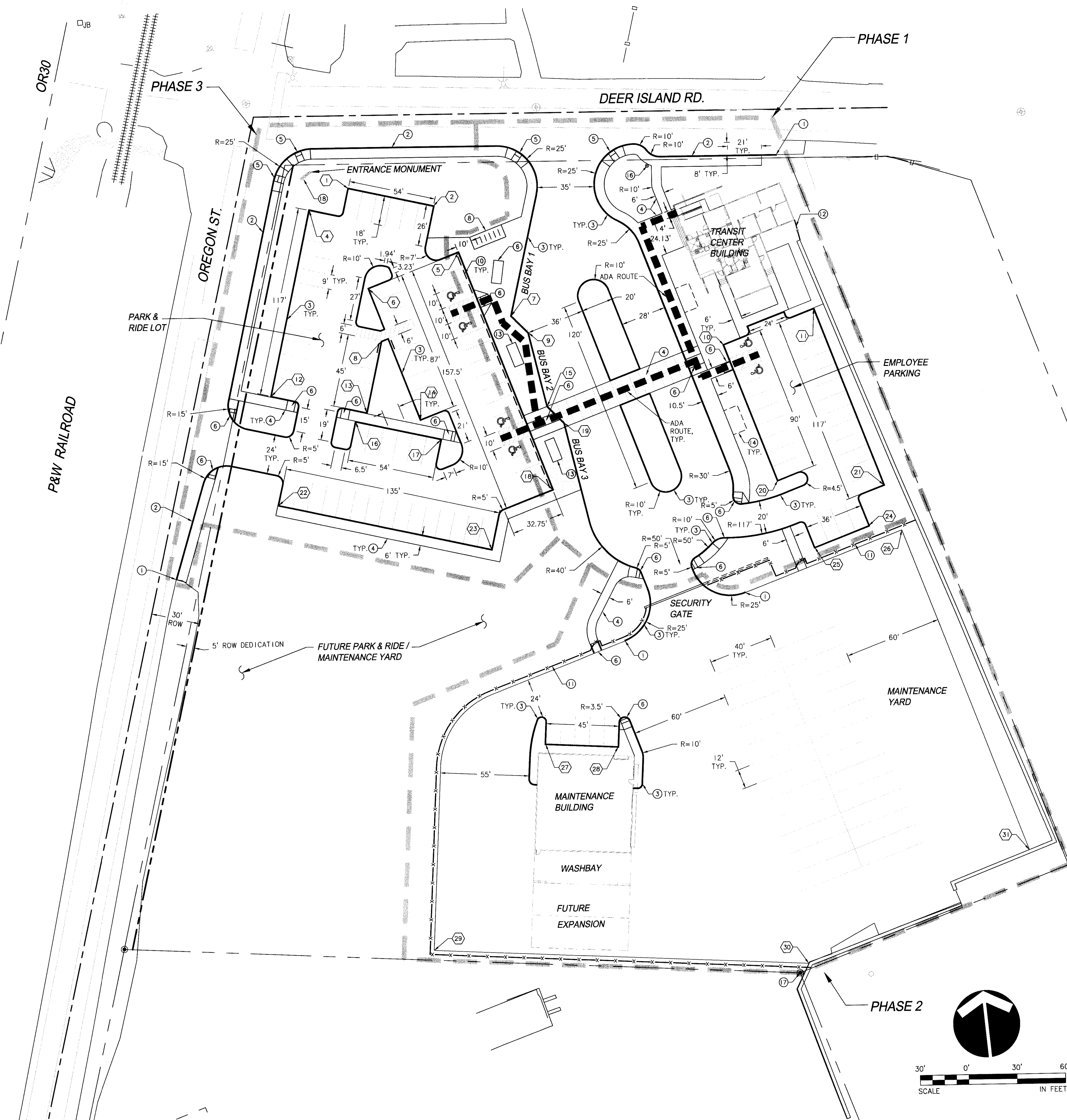

XREF LIST
Ltscale: 30
Resolved
S659X190
A-BD24-1
C659X230
A-BP-OUT
Unresolved
C659X100

Plot Date: LKO: AMANDM 09/29/2010 2:33pm --> Lake Oswego\Draw\G\C1.0.dwg
CAD File: C1.0.dwg